



NOTICE OF MEETING

Special Licensing Sub Committee

TUESDAY, 13TH JANUARY, 2009 at 19:30 HRS - CIVIC CENTRE, HIGH ROAD, WOOD GREEN, N22 8LE.

MEMBERS: Councillors Edge, Lister and Newton

AGENDA

1. ELECTION OF CHAIR FOR THE DURATION OF THE PROCEEDINGS

The Sub-Committee will be required to elect a Chair for the duration of the proceedings.

2. APOLOGIES FOR ABSENCE

3. URGENT BUSINESS

It being a special meeting of the Sub Committee, under Part Four, Section B, Paragraph 17, of the Council's Constitution, no other business shall be considered at the meeting.

4. DECLARATIONS OF INTEREST

A member with a personal interest in a matter who attends a meeting of the authority at which the matter is considered must disclose to that meeting the existence and nature of that interest at the commencement of that consideration, or when the interest becomes apparent.

A member with a personal interest in a matter also has a prejudicial interest in that matter if the interest is one which a member of the public with knowledge of the relevant facts would reasonably regard as so significant that it is likely to prejudice the member's judgement of the public interest **and** if this interest affects their financial position or the financial position of a person or body as described in paragraph 8 of the Code of Conduct **and/or** if it relates to the determining of any approval, consent, licence, permission or registration in relation to them or any person or body described in paragraph 8 of the Code of Conduct.

5. SUMMARY OF PROCEDURE (PAGES 1 - 2)

The Chair will explain the procedure that the Committee will follow for the hearing considered under the Licensing Act 2003. A copy of the procedure is attached.

6. DE LA TIERRA, 202 ARCHWAY ROAD, LONDON N6 5BA (PAGES 3 - 28)

To consider an application for the Provision of Regulated Entertainment, and Sale by retail of Alcohol at the above premises.

7. THE WESTBURY TAVERN, 57 WESTBURY AVENUE, WOOD GREEN, LONDON N22 6SA (PAGES 29 - 82)

To consider an application to allow extended hours for: Provision of Regulated Entertainment, Sale by retail of alcohol and to permit Provision of Late Night Refreshment at the above premises.

Yuniea Semambo
Head of Member Services
5th Floor
River Park House
225 High Road
Wood Green
London N22 8HQ

Helen Jones
Principal Committee Coordinator
(Non Cabinet Committees)
Tel: 020-8489 2615
Fax: 020-8489 2660
Email: helen.jones@haringey.gov.uk

Monday, 05 January 2009

LICENSING SUB-COMMITTEE HEARINGS PROCEDURE SUMMARY	
INTRODUCTION	
1.	The Chair introduces himself and invites other Members, Council officers, Police, Applicant and Objectors to do the same.
2.	The Chair invites Members to disclose any prior contacts (before the hearing) with the parties or representations received by them
3.	The Chair explains the procedure to be followed by reference to this summary which will be distributed.
NON-ATTENDANCE BY PARTY OR PARTIES	
4.	If one or both of the parties fails to attend, the Chair decides whether to:
	(i) grant an adjournment to another date, or
	(ii) proceed in the absence of the non-attending party.
	Normally, an absent party will be given one further chance to attend.
TOPIC HEADINGS	
5.	The Chair suggests the “topic headings” for the hearing. In the case of the majority of applications for variation of hours, or other terms and conditions, the main topic is:
	Whether the extensions of hours etc. applied for would conflict with the four licensing objectives i.e.
	(i) the prevention of crime and disorder,
	(ii) public safety,
	(iii) the prevention of public nuisance, and
	(iv) the protection of children from harm.
6.	The Chair invites comments from the parties on the suggested topic headings and decides whether to confirm or vary them.
WITNESSES	
7.	The Chair asks whether there are any requests by a party to call a witness and decides any such request.
8.	Only if a witness is to be called, the Chair then asks if there is a request by an opposing party to “cross-examine” the witness. The Chair then decides any such request.
DOCUMENTARY EVIDENCE	
9.	The Chair asks whether there are any requests by any party to introduce late documentary evidence.
10.	If so, the Chair will ask the other party if they object to the admission of the late documents.
11.	If the other party do object to the admission of documents which have only been produced by the first party at the hearing, then the documents shall not be admitted.

12.	If the other party object to documents produced late but before the hearing, the following criteria shall be taken into account when the Chair decides whether or not to admit the late documents:	
(i)	What is the reason for the documents being late?	
(ii)	Will the other party be unfairly taken by surprise by the late documents?	
(iii)	Will the party seeking to admit late documents be put at a major disadvantage if admission of the documents is refused?	
(iv)	Is the late evidence really important?	
(v)	Would it be better and fairer to adjourn to a later date?	
THE LICENSING OFFICER'S INTRODUCTION		
13.	The Licensing Officer introduces the report explaining, for example, the existing hours, the hours applied for and the comments of the other Council Services or outside official bodies. This should be as "neutral" as possible between the parties.	
14.	The Licensing Officer can be questioned by Members and then by the parties.	
THE HEARING		
15.	This takes the form of a discussion led by the Chair. The Chair can vary the order as appropriate but it should include:	
(i)	an introduction by the Objectors' main representative	
(ii)	an introduction by the Applicant or representative	
(iii)	questions put by Members to the Objectors	
(iv)	questions put by Members to the Applicant	
(v)	questions put by the Objectors to the Applicant	
(vi)	questions put by the Applicant to the Objectors	
CLOSING ADRESSES		
16.	The Chair asks each party how much time is needed for their closing address, if they need to make one.	
17.	Generally, the Objectors make their closing address before the Applicant who has the right to the final closing address.	
THE DECISION		
18.	Members retire with the Committee Clerk and legal representative to consider their decision including the imposition of conditions.	
19.	The decision is put in writing and read out in public by the Committee Clerk once Members have returned to the meeting.	

Licensing Act 2003 Sub-Committee on 13th January 2009 at 7.30.p.m

Report title: Application for a Premises Licence Application at DE LA TIERRA, 202 ARCHWAY ROAD, LONDON N6 5BA

Report of: The Lead Officer Licensing

Ward(s) affected Highgate

1. Purpose

To consider an application by Paul O'Hare and Helen Thompson to allow: Provision of Regulated Entertainment and Sale by retail of alcohol at the above premises.

2. Recommendations

- 2.1 (a) Grant the application as asked
 (b) Modify the conditions of the licence, by altering or omitting or adding to them
 (c) Reject the whole or part of the application

The Committee is asked to note that it may not modify the conditions or reject the whole or part of the application unless it is necessary to promote the licensing objectives.

Report authorised by: Robin Payne.....



Assistant Director Enforcement Services

Contact Officer: Ms Daliah Barrett -Williams

Telephone: 020 8489 8232

3. Executive summary

For consideration by Sub Committee under Licensing Act 2003 for a Premises licence with variation to the existing conditions

4. Access to information:

Local Government (Access to Information) Act 1985

Background Papers

The following Background Papers are used in the preparation of this Report:

File: DE LA TIERRA

The Background Papers are located at Techno park, Ashley Road, N17

5. REPORT

Background

5.1 An application for a Premises Licence, by Paul O'Hare and Helen Thompson in respect of De La Tierra, 202 Archway Road, London N6 5BA under the Licensing Act 2003.

5.2 Details of the application being sought under the Premises Licence APP1

Provision of Regulated Entertainment: Live and Recorded Music

Monday to Sunday 1100 to 2300

Supply of Alcohol

Monday to Sunday 1100 to 2300

Opening Hours

Monday to Sunday 1100 to 2330

General-all four licensing objectives

The licensee will intend to run a low-key tapas style bar with the emphasis on food rather than drink.

The premises will serve only draught beers and no alcopops.

The licensee will liaise with the Police and local authorities.

5.3 Crime and Disorder

The licensee will join any existing pub-watch scheme and setting up a 'Ring Round' procedure.

The licensee will encourage people to eat with their drinks.

The police telephone number will be kept next to the telephone.

5.4 Public Safety

The licensee will comply with all relevant fire and building regulations, all access areas will be kept free of obstructions.

Lighting will be provided for any outdoor areas.

5.5 Public Nuisance

The building will be soundproofed by the landlord.

All doors will be kept closed after 9pm.

The premises will refuse to serve anyone who appears to be drunk.

The premises will comply with the local council's waste programme.

5.6 Child Protection

The premises will adopt a proof of age scheme and join the PASS scheme and display the PASS poster.

Children will not be allowed in the premises after 9pm.

Condition added as agreed with the Police:

Alcohol may only be sold to individuals over the age of 18 with valid proof of identification with one of the following:

- A valid passport
- A photo driving license issued in a European Union Country
- A proof of age standard card system
- A citizen card, supported by the Home Office

6. RELEVANT REPRESENTATIONS (CONSULTATION)

Responsible authorities:

6.1 Comments of Metropolitan Police

The Police made representation on this application which has now been resolved.

6.2 Comments of Enforcement Services:

Noise Team

Have no objections to this application

Food Team

Have no objections to this application.

Health and Safety

Have no objections to this application

Trading Standards

Have no objections to this application

6.3 Fire Officer

Have made no representation against this application.

6.4 Planning Officer

Have no objections to this application

6.5 Comments of Child Protection Agency or Nominee

No representation made on this matter

7.0 Interested Parties – App 2

2 letters of representation have been received against this application.

8.0 Financial Comments

The fee which would be applicable for this application was **£190.00**.

AG 909 531

Application for a premises licence to be granted under the Licensing Act 2003

(1) HARINGEY COUNCIL

Reference number:

PLEASE READ THE FOLLOWING INSTRUCTIONS FIRST

Before completing this form please read the guidance notes at the end of the form. If you are completing this form by hand please write legibly in block capitals. In all cases ensure that your answers are inside the boxes and written in black ink. Use additional sheets if necessary. You may wish to keep a copy of the completed form for your records

(2) I/We PAUL O'HARE / HELEN THOMPSON

apply for a premises licence under section 17

the Licensing Act 2003 for the premises described in Part 1 below (the premises) and I/we are making this application to you as the relevant licensing authority in accordance with section 12 of the Licensing Act 2003

HARINGEY COUNCIL
ENVIRONMENTAL SERVICES DIRECTORATE
17 NOV 2008
RECEIVED
CIVIC CENTRE HIGH RD N22 8LE

Part 1 - Premises details

Postal address of premises or, if none, Ordnance Survey map reference or description
202 ARCHWAY ROAD

Post town LONDON Postcode N6 5BA

Telephone number at premises (if any)

Non-domestic rateable value of premises £ 3650.00

Part 2 - Applicant details

Please state whether you are applying for a premises licence as

- a) an individual or individuals* please complete section (A)
- b) a person other than an individual*
 - i. as a limited company please complete section (B)
 - ii. as a partnership please complete section (B)
 - iii. as an unincorporated association; or please complete section (B)
 - iv. other (for example a statutory corporation) please complete section (B)

(1) Insert name and address of relevant licensing authority and its reference number (optional)
(2) Insert name(s) of applicant

- c) a recognised club please complete section (B)
- d) a charity please complete section (B)
- e) the proprietor of an educational establishment please complete section (B)
- f) a health service body please complete section (B)
- g) a person who is registered under Part 2 of the Care Standards Act 2000 (c14) in respect of an independent hospital please complete section (B)
- h) the chief officer of police of a police force in England and Wales please complete section (B)

* If you are applying as a person described in (a) or (b) please confirm:

- I am carrying on or proposing to carry on a business which involves the use of the premises for licensable activities; or Please tick yes
- I am making the application pursuant to
 - a statutory function; or
 - a function discharged by virtue of Her Majesty's prerogative

(A) INDIVIDUAL APPLICANTS (fill in as applicable)

Mr Mrs Miss Ms Other title
 (for example, Rev)

Surname First names

I am 18 years old or over Please tick yes
 Date of birth

Day	Month	Year
0	6	1
2	1	9
7	1	7

Current postal address if different from premises address
 FLAT 2A
 19 HARINGEY PARK

Post town Postcode

Daytime contact telephone number

E-mail address (optional)

Mr

Mrs

Miss

Ms

Other title (for example, Rev)

Surname

First names

THOMPSON

HELEN

I am 18 years old or over Please tick yes

Date of birth

Day	Month	Year
1	6	09
1	9	58

Current postal address if different from premises address

FLAT 2A
19 HARINGEY PARK

Post town LONDON

Postcode N8 9HY

Daytime contact telephone number

0208 348 6674

E-mail address (optional)

INFO @ DELATIERRA . CO. UK

(B) OTHER APPLICANTS

Please provide name and registered address of applicant in full. Where appropriate please give any registered number. In the case of a partnership or other joint venture (other than a body corporate), please give the name and address of each party concerned.

Name
Address
Registered number (where applicable)
Description of applicant (for example partnership, company, unincorporated association etc.)
Telephone number (if any)
E-mail address (optional)

When do you want the premises licences to start?

Day	Month	Year
09	12	2008

If you wish the licence to be valid only for a limited period, when do you want it to end?

Day	Month	Year

Please give a general description of the premises (please read guidance note 1)

THE PREMISES CONSIST OF A GROUND FLOOR AND BASEMENT OF A LOCK UP SHOP IN A ROW OF SHOPS ON THE ARCHWAY ROAD.

WE INTEND TO USE THE GROUND FLOOR FOR A SMALL KITCHEN AND BAR AREA TO PROVIDE SPANISH FOOD FOR APPROXIMATELY 15 COVERS. SOME CASUAL SOFAS AND BAR STOOLS WILL BE ALSO ON THE GROUND FLOOR. THE WC WILL BE LOCATED IN THE BASEMENT BUT THIS AREA WILL NOT BE USED FOR SEATING.

THERE IS A SMALL COURTYARD TO THE REAR ACESSED BY A SPIRAL STAIRCASE.

If 5,000 or more people are expected to attend the premises at any one time, please state the number expected to attend

--

Provision of regulated entertainment

- Please tick yes
- a) plays (if ticking yes, fill in box A)
 - b) films (if ticking yes, fill in box B)
 - c) indoor sporting events (if ticking yes, fill in box C)
 - d) boxing or wrestling entertainment (if ticking yes, fill in box D)
 - e) live music (if ticking yes, fill in box E)
 - f) recorded music (if ticking yes, fill in box F)
 - g) performances of dance (if ticking yes, fill in box G)
 - h) anything of a similar description to that falling within (e), (f) or (g) (if ticking yes, fill in box H)

Provision of entertainment facilities for:

- i) making music (if ticking yes, fill in box I)
- j) dancing (if ticking yes, fill in box J)
- k) entertainment of a similar description to that falling within (i) or (j) (if ticking yes, fill in box K)

Provision of late night refreshment (if ticking yes, fill in box L)

Supply of alcohol (if ticking yes, fill in box M)

In all cases complete boxes N, O and P

A

Page 12

Plays			Will the performance of a play take place indoors or outdoors or both - please tick <input checked="" type="checkbox"/> (please read guidance note 2)
Standard days and timings (please read guidance note 6)			
Day	Start	Finish	Indoors <input type="checkbox"/> Outdoors <input type="checkbox"/> Both <input type="checkbox"/>
Mon			Please give further details here (please read guidance note 3)
Tue			State any seasonal variations for performing plays (please read guidance note 4)
Wed			Non-standard timings. Where you intend to use the premises for the performance of plays at different times from those listed in the column on the left, please list (please read guidance note 5)
Thur			
Fri			
Sat			
Sun			

B

Films			Will the exhibition of films take place indoors or outdoors or both - please tick <input checked="" type="checkbox"/> (please read guidance note 2)
Standard days and timings (please read guidance note 6)			
Day	Start	Finish	Indoors <input type="checkbox"/> Outdoors <input type="checkbox"/> Both <input type="checkbox"/>
Mon			Please give further details here (please read guidance note 3)
Tue			State any seasonal variations for the exhibition of films (please read guidance note 4)
Wed			Non-standard timings. Where you intend to use the premises for the exhibition of films at different times from those listed in the column on the left, please list (please read guidance note 5)
Thur			
Fri			
Sat			
Sun			

Page 13

Indoor sporting events			Please give further details here. (please read guidance note 3)
Day	Start	Finish	
Mon			
Tue			State any seasonal variations for indoor sporting events (please read guidance note 4)
Wed			Non-standard timings. Where you intend to use the premises for indoor sporting events at different times from those listed in the column on the left, please list (please read guidance note 5)
Thur			
Fri			
Sat			
Sun			

D

Boxing or wrestling entertainments			Will the boxing or wrestling entertainment take place indoors or outdoors or both - please tick <input checked="" type="checkbox"/> (please read guidance note 2)
Day	Start	Finish	
Mon			Indoors <input type="checkbox"/> Outdoors <input type="checkbox"/> Both <input type="checkbox"/>
			Please give further details here (please read guidance note 3)
Tue			State any seasonal variations for boxing or wrestling entertainment (please read guidance note 4)
Wed			Non-standard timings. Where you intend to use the premises for boxing or wrestling entertainment at different times from those listed in the column on the left, please list (please read guidance note 5)
Thur			
Fri			
Sat			
Sun			

E

Page 14

Live music			Will the performance of live music take place indoors or outdoors or both - please tick <input checked="" type="checkbox"/> (please read guidance note 2)
Day	Start	Finish	
Standard days and timings (please read guidance note 6)			Indoors <input checked="" type="checkbox"/> Outdoors <input type="checkbox"/> Both <input type="checkbox"/>
Mon	11.00	23.00	Please give further details here (please read guidance note 3) OCCASIONAL LIVE MUSIC FOR EXAMPLE SPANISH GUITARIST ON A FRIDAY NIGHT
Tue	11.00	23.00	
Wed	11.00	23.00	State any seasonal variations for the performance of live music (please read guidance note 4)
Thur	11.00	23.00	
Fri	11.00	23.00	Non-standard timings. Where you intend to use the premises for the performance of live music at different times from those listed in the column on the left, please list (please read guidance note 5)
Sat	11.00	23.00	
Sun	11.00	23.00	

F

Recorded music			Will the playing of recorded music take place indoors or outdoors or both - please tick <input checked="" type="checkbox"/> (please read guidance note 2)
Day	Start	Finish	
Standard days and timings (please read guidance note 6)			Indoors <input checked="" type="checkbox"/> Outdoors <input type="checkbox"/> Both <input type="checkbox"/>
Mon	11.00	23.00	Please give further details here (please read guidance note 3) OCCASIONAL BACKGROUND MUSIC CD'S TO BE PLAYED IN BAR
Tue	11.00	23.00	
Wed	11.00	23.00	State any seasonal variations for the playing of recorded music (please read guidance note 4)
Thur	11.00	23.00	
Fri	11.00	23.00	Non-standard timings. Where you intend to use the premises for the playing of recorded music entertainment at different times from those listed in the column on the left, please list (please read guidance note 5)
Sat	11.00	23.00	
Sun	11.00	23.00	

Performances of dance			Will the performance of dance take place indoors or outdoors or both - please tick <input checked="" type="checkbox"/> (please read guidance note 2)
Day	Start	Finish	
Standard days and timings (please read guidance note 6)			Indoors <input type="checkbox"/> Outdoors <input type="checkbox"/> Both <input type="checkbox"/>
Mon			Please give further details here (please read guidance note 3)
Tue			
Wed			State any seasonal variations for the performance of dance (please read guidance note 4)
Thur			
Fri			Non-standard timings. Where you intend to use the premises for the performance of dance entertainment at different times from those listed in the column on the left, please list (please read guidance note 5)
Sat			
Sun			

Anything of a similar description to that falling within (e), (f) or (g)			Please give a description of the type of entertainment you will be providing
Day	Start	Finish	
Standard days and timings (please read guidance note 6)			
Mon			Will this entertainment take place indoors or outdoors or both - please tick <input checked="" type="checkbox"/> (please read guidance note 2)
			Indoors <input type="checkbox"/> Outdoors <input type="checkbox"/> Both <input type="checkbox"/>
Tue			Please give further details here (please read guidance note 3)
Wed			
Thur			State any seasonal variations for entertainment of a similar description to that falling within (e), (f) or (g) (please read guidance note 4)
Fri			
Sat			Non-standard timings. Where you intend to use the premises for the entertainment of similar description to that falling within (e), (f) or (g) at different times from those listed in the column on the left, please list (please read guidance note 5)
Sun			

Provision of facilities for making music

Standard days and timings
(please read guidance note 6)

Day	Start	Finish
Mon		
Tue		
Wed		
Thur		
Fri		
Sat		
Sun		

Please give a description of the facilities for making music you will be providing

Will the facilities for making music be indoors or outdoors or both
- please tick (please read guidance note 2)

Indoors Outdoors Both

Please give further details here (please read guidance note 3)

State any seasonal variations for the provision of facilities for making music
(please read guidance note 4)

Non-standard timings. Where you intend to use the premises for provision of facilities for making music at different times from those listed in the column on the left, please list (please read guidance note 5)

J

Provision of facilities for dancing

Standard days and timings
(please read guidance note 6)

Day	Start	Finish
Mon		
Tue		
Wed		
Thur		
Fri		
Sat		
Sun		

Please give a description of the facilities for dancing you will be providing

Will the facilities for dancing be indoors or outdoors or both
- please tick (please read guidance note 2)

Indoors Outdoors Both

Please give further details here (please read guidance note 3)

State any seasonal variations for providing dancing facilities
(please read guidance note 4)

Non-standard timings. Where you intend to use the premises for the provision of facilities for dancing entertainment at different times from those listed in the column of the left, please list (please read guidance note 5)

Provision of facilities for entertainment of a similar description to that falling within I or J

Please give a description of the type of entertainment facility you will be providing

Standard days and timings (please read guidance note 6)

Will the entertainment facility be indoors or outdoors or both - please tick (please read guidance note 2)

Indoors Outdoors Both

Day	Start	Finish
Mon		
Tue		
Wed		
Thur		
Fri		
Sat		
Sun		

Please give further details here (please read guidance note 3)

State any seasonal variations for the provision of facilities for entertainment of a similar description to that falling within I or J (please read guidance note 4)

Non-standard timings. Where you intend to use the premises for the provision of facilities for entertainment of a similar description to that falling within I or J at different times from those listed in the column on the left, please list (please read guidance note 5)

Late night refreshment			Will the provision of late night refreshment take place indoors or outdoors or both - please tick <input checked="" type="checkbox"/> (please read guidance note 2)
Standard days and timings (please read guidance note 6)			
Day	Start	Finish	Indoors <input type="checkbox"/> Outdoors <input type="checkbox"/> Both <input type="checkbox"/>
Mon			Please give further details here (please read guidance note 3)
Tue			
Wed			State any seasonal variations for the provision of late night refreshment (please read guidance note 4)
Thur			
Fri			Non-standard timings. Where you intend to use the premises for the provision of late night refreshment at different times from those listed in the column on the left, please list (please read guidance note 5)
Sat			
Sun			

M

Supply of alcohol			Will the sale of alcohol be for consumption - please tick box <input checked="" type="checkbox"/> (please read guidance note 7)
Standard days and timings (please read guidance note 6)			
Day	Start	Finish	On the premises <input checked="" type="checkbox"/> Off the premises <input type="checkbox"/> Both <input type="checkbox"/>
Mon	11.00	23.00	State any seasonal variations for the supply of alcohol (please read guidance note 4) NEW YEARS EVE TILL 1.00am
Tue	11.00	23.00	
Wed	11.00	23.00	Non-standard timings. Where you intend to use the premises for the supply of alcohol at different times from those listed in the column on the left, please list (please read guidance note 5)
Thur	11.00	23.00	
Fri	11.00	23.00	
Sat	11.00	23.00	
Sun	11.00	23.00	

Name PAUL O'HARE Page 19
 Address 2a
 19 HARINGEY PARK, LONDON
 Postcode N8 9HY
 Personal Licence number (if known) LN/0000 6474
 Issuing licensing authority (if known) HARINGEY

N

Please highlight any adult entertainment or services, activities, other entertainment or matters ancillary to the use of the premises that may give rise to concern in respect of children (please read guidance note 8)

NONE

O

Hours premises are open to the public
 Standard days and timings (please read guidance note 6)

State any seasonal variations (please read guidance note 4)

NEW YEARS EVE OPEN TILL 1.00am

Day	Start	Finish
Mon	11.00	23.30
Tue	11.00	23.30
Wed	11.00	23.30
Thur	11.00	23.30
Fri	11.00	23.30
Sat	11.00	23.30
Sun	11.00	23.30

Non-standard timings. Where you intend to use the premises to be open to the public at different times from those listed in the column on the left, please list (please read guidance note 5)

* open till 11.30pm every night to allow drinking up time.

a) General - all four licensing objectives (b, c, d, e) (please read guidance note 9)

WE INTEND TO RUN A LOW KEY TAPAS STYLE BAR WITH THE EMPHASIS ON FOOD RATHER THAN DRINK. WE WILL BE SERVING ONLY TWO DRAUGHT BEERS AND NO ALCO POPS. WE WILL LIASE WITH THE POLICE AND OTHER AUTHORITIES,

b) The prevention of crime and disorder

WE WILL BE JOINING ANY EXSITING PUB-WATCH SCHEME AND SETTING UP A 'RING ROUND' PROCEDURE. WE WILL ENCOURAGE PEOPLE TO EAT WITH THE DRINK. WE WILL KEEP THE POLICE NUMBER NEXT TO PHONE

c) Public safety

WE WILL COMPLY WITH ALL RELEVANT FIRE AND BULDING REGULATIONS, WE WILL KEEP ALL ACESS AREAS FREE OF OBSTRUCTIONS. WE WILL PROVIDE LIGHTING FOR ANY OUTDOOR AREAS.

d) The prevention of public nuisance

THE BUILDING HAS BEEN SOUND PROOFED BY THE LANDLORD. WE WILL KEEP ALL DOORS CLOSED AFTER 9.00pm. REFUSE TO SERVE ANY PERSON APPEARING DRUNK. COMPLY WITH LOCAL COUNCILS WASTE PROGRAMME.

e) The protection of children from harm

WE WILL ADOPT A PROOF OFF AGE SCHEME AND JOIN PASS SCHEME AND DISPLAY PASS) POSTER. WILL NOT BE ALLOWING CHLLDREN IN THE BAR AFTER 9.00pm

CHECKLIST:

Please tick ✓

- I have made or enclosed payment of the fee
- I have enclosed the plan of the premises
- I have sent copies of this application and the plan to responsible authorities and others where applicable
- I have enclosed the consent form completed by the individual I wish to be premises supervisor, if applicable
- I understand that I must now advertise my application
- I understand that if I do not comply with the above requirements my application will be rejected

IT IS AN OFFENCE, LIABLE ON CONVICTION TO A FINE UP TO LEVEL 5 ON THE STANDARD SCALE, UNDER SECTION 158 OF THE LICENSING ACT 2003 TO MAKE A FALSE STATEMENT IN OR IN CONNECTION WITH THIS APPLICATION

Part 4 - Signatures (please read guidance note 10)

Signature of applicant or applicant's solicitor or other duly authorised agent. (Please read guidance note 11)
If signing on behalf of the applicant please state in what capacity.

Signature Paul Mithras

Date 04 11 08

Capacity

For joint applications signature of 2nd applicant, 2nd applicant's solicitor or other authorised agent.
(Please read guidance note 12)

If signing on behalf of the applicant please state in what capacity.

Signature Allen Thryson

Date 04.11.08

Capacity

Contact name (where not previously given) and postal address for correspondence associated with this application (please read guidance note 13)	
Post town	Postcode
Telephone number (if any)	
If you would prefer us to correspond with you by e-mail your e-mail address (optional)	

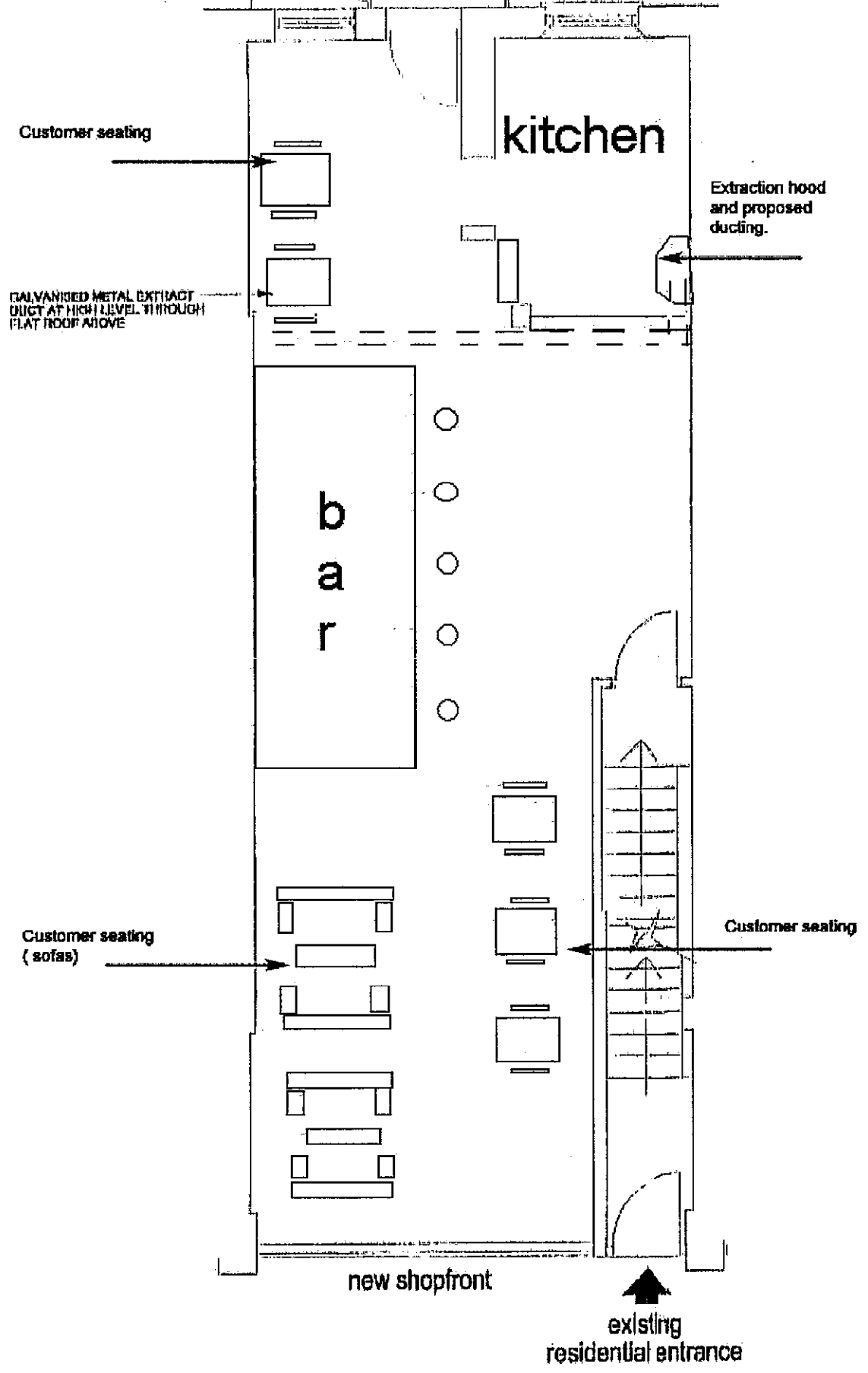

GROUND FLOOR LAYOUT

rear yard

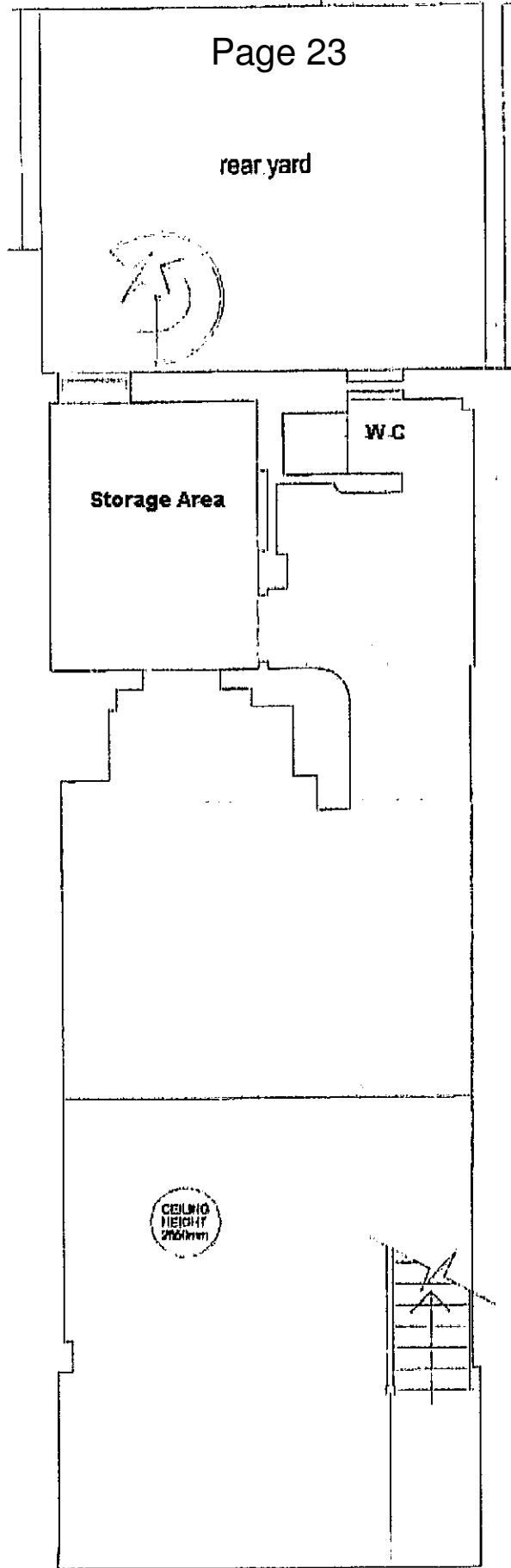

BASEMENT LAYOUT

Daliah Barrett
Lead Licensing Officer
1st Floor
Lee valley Technopark
Ashley Road
Tottenham
London
N17 9L N.

6C Northwood Road
Highgate
London
N6 5TN

8th December 2008

Dear Ms Barrett

Re: REPRESENTATION RELATING TO LICENSING ACT 2003 AND DE LA TIERRA, 202
ARCHWAY RD, HIGHGATE, LONDON, N6 5BA.

I would like to draw your attention to the following concern relating to the licensing objective:
'the prevention of public nuisance'.

I am concerned about noise disturbance in relation to the premises De La Tierra at 202 Archway Road if live recorded music is played between the hours 1100 to 2300. I have experienced noise disturbance in the past from disco music at a premises on Wembury Road N6. I raised my concerns with Haringey noise disturbance team and the problem was resolved. I do not wish to be placed in this position again and so would therefore request that there is a noise limit policy in place as part of the licensing agreement.

Yours sincerely



SL Bach

Olson Kendra

From: Stephanie Bach [slbach@tiscali.co.uk]
Sent: 09 December 2008 20:26
To: Olson Kendra
Subject: Fwd: REPRESENTATION RELATING TO LICENSING ACT 2003 & DE LATIERRE, 202 ARCHWAY ROAD, HIGHGATE, N6 5BA
Follow Up Flag: Follow up
Flag Status: Completed

Begin forwarded message:

From: Stephanie Bach <slbach@tiscali.co.uk>
Date: 8 December 2008 22:14:06 GMT
To: kendra.olsen@haringey.gov.uk
Cc: daliah.barrett@haringey.gov.uk
Subject: Re: REPRESENTATION RELATING TO LICENSING ACT 2003 & DE LATIERRE, 202 ARCHWAY ROAD, HIGHGATE, N6 5BA

Kendra Olsen **6C Northwood Road**
Licensing Team Highgate
1st Floor London
Lee valley Technopark N6 5TN
Ashley Road
Tottenham
London 8th December 2008
N17 9LN

Dear Ms Olson

Re: REPRESENTATION RELATING TO LICENSING ACT 2003 AND DE LA TIERRA, 202 ARCHWAY RD, HIGHGATE, LONDON, N6 5BA.

Further to my telephone conversation with you on 8th December 2008, I would like to draw your attention to the following concern relating to the licensing objective: 'the prevention of public nuisance'.

I am concerned about noise disturbance in relation to the premises De La Tierra at 202 Archway Road if live recorded music is played between the hours 1100 to 2300. I have experienced noise disturbance in the past from disco music at a premises on Wembury Road N6. I raised my concerns at this time with Haringey noise disturbance team and the problem was resolved. I

do not wish to be placed in this position again and so would therefore request that there is a noise limit policy in place as part of the licensing agreement.

Yours sincerely

SL Bach

This email has been scanned by the MessageLabs Email Security System.
For more information please visit <http://www.messagelabs.com/email>

/ Rd

iber 2008

FILED

tion for a premises license for DE LA TIERRA, 202 Archway Rd, N6 5BA

Barrett,

nt of Wembury Rd, N6 I am writing to make a representation against the above application.

are that it would be a **public nuisance**, i.e. noise pollution from the live and recorded music potentially 7
ek, more traffic in the area and non-residents parking in Wembury Rd and taking up the already limited
ces, customers smoking on the street creating noise and litter.

eady a club almost opposite the proposed site at 202 Archway Rd which has created all of the above issues.

ely residential area, home to many families with young children and with the proposed premises being in
roximity these homes I have to object.

rely,

uels.



This page is intentionally left blank

Licensing Act 2003 Sub-Committee on 13th January 2009 at 7.30.p.m

Report title: Application for a Premises Licence Variation at THE WESTBURY TAVERN, 57 WESTBURY AVENUE, WOOD GREEN, LONDON N22 6SA

Report of: The Lead Officer Licensing

Ward(s) affected Noel Park

1. Purpose

To consider an application by Punch Taverns Plc to allow extended hours for: Provision of Regulated Entertainment, Sale by retail of alcohol and to permit Provision of Late Night Refreshment at the above premises.

2. Recommendations

- 2.1**
- (a) Grant the application as asked
 - (b) Modify the conditions of the licence, by altering or omitting or adding to them
 - (c) Reject the whole or part of the application

The Committee is asked to note that it may not modify the conditions or reject the whole or part of the application unless it is necessary to promote the licensing objectives.

Report authorised by: Robin Payne.....

 Assistant Director Enforcement Services

Contact Officer: Ms Daliah Barrett -Williams

Telephone: 020 8489 8232

3. Executive summary

For consideration by Sub Committee under Licensing Act 2003 for a Premises licence with variation to the existing conditions

4. Access to information:

Local Government (Access to Information) Act 1985

Background Papers

The following Background Papers are used in the preparation of this Report:

File: THE WESTBURY TAVERN

The Background Papers are located at Enforcement Service, Technopark, Ashley Road, Tottenham N17

This page is intentionally left blank

5. REPORT**Background**

5.1 An application for a Premises Licence Variation, by Punch Taverns in respect of The Westbury Tavern, 57 Westbury Avenue, Wood Green, London N22 6SA under the Licensing Act 2003.

5.2 Details of the application being sought under the Premises Licence Variation
APP1

Provision of Regulated Entertainment:

Live Music, Recorded Music, Provision of facilities for dancing, Provision of facilities for entertainment of a similar description to that of making music or dancing:

Sunday to Thursday	1000 to 0000
Friday & Saturday	1000 to 0200

Provision of Late Night Refreshment:

Sunday to Thursday	2300 to 0000
Friday & Saturday	2300 to 0200

Supply of alcohol:

Sunday to Thursday	1000 to 0000
Friday & Saturday	1000 to 0200

All licensable activities:

A further additional hour into the morning following every Friday, Saturday, Sunday and Monday for each May Bank Holiday, Spring/Whitsun Bank Holiday and every August Bank Holiday weekend. A further additional hour into the morning following every Thursday, Friday, Saturday, Sunday and Monday for the Easter Bank Holiday weekend. A further additional hour every Christmas Eve and Boxing Day. From the start of permitted hours New Years Eve to the close of permitted hours New Years Day. A further additional hour into the morning every St David's Day, St Patrick's Day, St George's Day and St Andrew's Day.

Hours premises are open to the public:

Sunday to Thursday	1000 to 0030
Friday & Saturday	1000 to 0230

A further additional hour into the morning following every Friday, Saturday, Sunday and Monday for each May Bank Holiday, Spring/Whitsun Bank Holiday and every August Bank Holiday weekend. A further additional hour into the morning following every Thursday, Friday, Saturday, Sunday and Monday for the Easter Bank Holiday weekend. A further additional hour every Christmas Eve and Boxing Day. From the

start of permitted hours New Years Eve to the close of permitted hours New Years Day. A further additional hour into the morning every St David's Day, St Patrick's Day, St George's Day and St Andrew's Day.

Please note that the layout of the premises will remain unchanged.

General-all four licensing objectives

As per current licence.

5.3 Crime and Disorder

5.4 Public Safety

5.5 Public Nuisance

5.6 Child Protection

6. RELEVANT REPRESENTATIONS (CONSULTATION)

Responsible authorities:

6.1 Comments of Metropolitan Police –APP 2

The Police have made representation on this application.

6.2 Comments of Enforcement Services:

Noise Team –APP 3

Have made objections to this application

Food Team

Have no objections to this application.

Health and Safety

Have no objections to this application

Trading Standards

Have no objections to this application

6.3 Fire Officer

Have no objections to this application

6.4 Planning Officer

Have no objections to this application

6.5 Comments of Child Protection Agency or Nominee

No representation made on this matter

7.0 Interested Parties – App 4

Letters of representation have been received against this application.

8.0 Financial Comments

The fee which would be applicable for this application was **£190.00**.

APPENDIX 1

APPLICATION FORM

Application to vary a premises licence under the Licensing Act 2003

PLEASE READ THE FOLLOWING INSTRUCTIONS FIRST

Before completing this form please read the guidance notes at the end of the form.
If you are completing this form by hand please write legibly in block capitals. In all cases ensure that your answers are inside the boxes and written in black ink. Use additional sheets if necessary.

You may wish to keep a copy of the completed form for your records.

I/We Punch Taverns Plc

(Insert name(s) of applicant)

being the premises licence holder, apply to vary a premises licence under section 34 of the Licensing Act 2003 for the premises described in Part 1 below

Premises licence number LN00003543
--

Part 1 – Premises Details

Postal address of premises or, if none, ordnance survey map reference or description Westbury 57 Westbury Avenue Wood Green			
Post town	London	Post code	N22 6SA
Telephone number at premises (if any)		020 8888 2045	
Non-domestic rateable value of premises		£29300	

Part 2 – Applicant details

Daytime contact telephone number	01283 501 600		
E-mail address (optional)	n/a		
Current postal address if different from premises address	Jubilee House Second Avenue Burton Upon Trent Staffordshire DE14 2WF		
Post Town	Burton Upon Trent	Postcode	DE14 2WF

Part 3 - Variation

Please tick yes

Do you want the proposed variation to have effect as soon as possible?

If not do you want the variation to take effect from

Day		Month		Year	

Please describe briefly the nature of the proposed variation (Please see guidance note 1)

To permit live music, recorded music, provision of facilities for dancing, karaoke and sale of alcohol Sunday to Thursday 10:00h until 00:00h and Friday and Saturday 10:00h until 02:00h.

To permit late night refreshment Sunday to Thursday 23:00h until 00:00h and Friday and Saturday 23:00h until 02:00h.

An additional thirty minutes drinking up time on top of the last permitted sale of alcohol.

For all of the above a further additional hour into the morning following every, Friday, Saturday, Sunday and Monday for each May Bank Holiday, Spring/Whitsun Bank Holiday and every August Bank Holiday weekend. A further additional hour into the morning following every Thursday, Friday, Saturday, Sunday and Monday for the Easter Bank Holiday weekend. A further additional hour every Christmas Eve and Boxing Day. From the start of permitted hours New Years Eve to the close of permitted hours New Years Day. A further additional hour into the morning every St.Davd's Day, St.Patrick's Day, St.George's Day and St.Andrew's Day.

If your proposed variation would mean that 5,000 or more people are expected to attend the premises at any one time, please state the number expected to attend

0

Part 4 Operating Schedule

Please complete those parts of the Operating Schedule below which would be subject to change if this application to vary is successful.

Provision of regulated entertainment

Please tick yes

- | | |
|--|-------------------------------------|
| a) plays (if ticking yes, fill in box A) | <input type="checkbox"/> |
| b) films (if ticking yes, fill in box B) | <input type="checkbox"/> |
| c) indoor sporting events (if ticking yes, fill in box C) | <input type="checkbox"/> |
| d) boxing or wrestling entertainment (if ticking yes, fill in box D) | <input type="checkbox"/> |
| e) live music (if ticking yes, fill in box E) | <input checked="" type="checkbox"/> |
| f) recorded music (if ticking yes, fill in box F) | <input checked="" type="checkbox"/> |
| g) performances of dance (if ticking yes, fill in box G) | <input type="checkbox"/> |
| h) anything of a similar description to that falling within (e), (f) or (g)
(if ticking yes, fill in box H) | <input type="checkbox"/> |

Provision of entertainment facilities:

- | | |
|--|-------------------------------------|
| i) making music (if ticking yes, fill in box I) | <input type="checkbox"/> |
| j) dancing (if ticking yes, fill in box J) | <input checked="" type="checkbox"/> |
| k) entertainment of a similar description to that falling within (i) or (j)
(if ticking yes, fill in box K) | <input checked="" type="checkbox"/> |

Provision of late night refreshment (if ticking yes, fill in box L)**Sale by retail of alcohol (if ticking yes, fill in box M)**

In all cases complete boxes N, O and P

A

Plays Standard days and timings (please read guidance note 6)			Will the performance of a play take place indoors or outdoors or both – please tick (please read guidance note 2)	Indoors	<input type="checkbox"/>
				Outdoors	<input type="checkbox"/>
				Both	<input type="checkbox"/>
Day	Start	Finish			
Mon			Please give further details here (please read guidance note 3)		
Tue					
Wed			State any seasonal variations for performing plays (please read guidance note 4)		
Thur					
Fri			Non standard timings. Where you intend to use the premises for the performance of plays at different times to those listed in the column on the left, please list (please read guidance note 5)		
Sat					
Sun					

B

Films Standard days and timings (please read guidance note 6)			Will the exhibition of films take place indoors or outdoors or both – please tick (please read guidance note 2)	Indoors	<input type="checkbox"/>
				Outdoors	<input type="checkbox"/>
				Both	<input type="checkbox"/>
Day	Start	Finish	Please give further details here (please read guidance note 3)		
Mon					
Tue			State any seasonal variations for the exhibition of films (please read guidance note 4)		
Wed					
Thur			Non standard timings. Where you intend to use the premises for the exhibition of films at different times to those listed in the column on the left, please list (please read guidance note 5)		
Fri					
Sat					
Sun					

C

Indoor sporting events Standard days and timings (please read guidance note 6)			<u>Please give further details</u> (please read guidance note 3)
Day	Start	Finish	
Mon			
Tue			<u>State any seasonal variations for indoor sporting events</u> (please read guidance note 4)
Wed			
Thur			<u>Non standard timings. Where you intend to use the premises for indoor sporting events at different times to those listed in the column on the left, please list</u> (please read guidance note 5)
Fri			
Sat			
Sun			

D

Boxing or wrestling entertainments Standard days and timings (please read guidance note 6)			Will the boxing or wrestling entertainment take place indoors or outdoors or both – please tick (please read guidance note 2)	Indoors	<input type="checkbox"/>
				Outdoors	<input type="checkbox"/>
				Both	<input type="checkbox"/>
Day	Start	Finish	Please give further details here (please read guidance note 3)		
Mon					
Tue					
Wed			State any seasonal variations for boxing or wrestling entertainment (please read guidance note 4)		
Thur			Non standard timings. Where you intend to use the premises for boxing or wrestling entertainment at different times to those listed in the column on the left, please list (please read guidance note 5)		
Fri					
Sat					
Sun					

E

Live music Standard days and timings (please read guidance note 6)			Will the performance of live music take place indoors or outdoors or both – please tick (please read guidance note 2)	Indoors	<input checked="" type="checkbox"/>		
Day				Start	Finish	Outdoors	<input type="checkbox"/>
Day				Start	Finish	Both	<input type="checkbox"/>
Day				Start	Finish		
Mon	10:00	00:00	Please give further details here (please read guidance note 3) As per current licence permission.				
Tue	10:00	00:00					
Wed	10:00	00:00	State any seasonal variations for the performance of live music (please read guidance note 4)				
Thur	10:00	00:00					
Fri	10:00		Non standard timings. Where you intend to use the premises for the performance of live music at different times to those listed in the column on the left, please list (please read guidance note 5) A further additional hour into the morning following every, Friday, Saturday, Sunday and Monday for each May Bank Holiday, Spring/Whitsun Bank Holiday and every August Bank Holiday weekend. A further additional hour into the morning following every Thursday, Friday, Saturday, Sunday and Monday for the Easter Bank Holiday weekend. A further additional hour every Christmas Eve and Boxing Day. From the start of permitted hours New Years Eve to the close of permitted hours New Years Day. A further additional hour into the morning every St.David's Day, St.Patrick's Day, St.George's Day and St.Andrew's Day.				
Sat		02:00					
Sun		02:00					
	10:00	00:00					

F

Recorded music Standard days and timings (please read guidance note 6)			<u>Will the playing of recorded music take place indoors or outdoors or both – please tick</u> (please read guidance note 2)	Indoors	<input type="checkbox"/>
				Outdoors	<input type="checkbox"/>
				Both	<input type="checkbox"/>
Day	Start	Finish	<u>Please give further details here</u> (please read guidance note 3) As per current licence permission.		
Mon	10:00	00:00			
Tue	10:00	00:00	<u>State any seasonal variations for the playing of recorded music</u> (please read guidance note 4)		
Wed	10:00	00:00	<u>Non standard timings. Where you intend to use the premises for the playing of recorded music at different times to those listed in the column on the left, please list</u> (please read guidance note 5) A further additional hour into the morning following every, Friday, Saturday, Sunday and Monday for each May Bank Holiday, Spring/Whitsun Bank Holiday and every August Bank Holiday weekend. A further additional hour into the morning following every Thursday, Friday, Saturday, Sunday and Monday for the Easter Bank Holiday weekend. A further additional hour every Christmas Eve and Boxing Day. From the start of permitted hours New Years Eve to the close of permitted hours New Years Day. A further additional hour into the morning every St.Davd's Day, St.Patrick's Day, St.George's Day and St.Andrew's Day.		
Thur	10:00	00:00			
Fri	10:00				
Sat		02:00			
	10:00				
Sun		02:00			
	10:00	00:00			

G

Performances of dance Standard days and timings (please read guidance note 6)			Will the performance of dance take place indoors or outdoors or both – please tick (please read guidance note 2)	Indoors	<input type="checkbox"/>
				Outdoors	<input type="checkbox"/>
				Both	<input type="checkbox"/>
Day	Start	Finish	Please give further details here (please read guidance note 3)		
Mon					
Tue			State any seasonal variations for the performance of dance (please read guidance note 4)		
Wed					
Thur			Non standard timings. Where you intend to use the premises for the performance of dance at different times to those listed in the column on the left, please list (please read guidance note 5)		
Fri					
Sat					
Sun					

H

<p>Anything of a similar description to that falling within (e), (f) or (g) Standard days and timings (please read guidance note 6)</p>			<p><u>Please give a description of the type of entertainment you will be providing</u></p>		
Day	Start	Finish	<p><u>Will this entertainment take place indoors or outdoors or both – please tick</u> (please read guidance note 2)</p>	Indoors	<input type="checkbox"/>
Mon				Outdoors	<input type="checkbox"/>
				Both	<input type="checkbox"/>
Tue			<p><u>Please give further details here</u> (please read guidance note 3)</p>		
Wed					
Thur			<p><u>State any seasonal variations for entertainment of a similar description to that falling within (e), (f) or (g)</u> (please read guidance note 4)</p>		
Fri					
Sat			<p><u>Non standard timings. Where you intend to use the premises for the entertainment of a similar description to that falling within (e), (f) or (g) at different times to those listed in the column on the left, please list</u> (please read guidance note 5)</p>		
Sun					

I

Provision of facilities for making music Standard days and timings (please read guidance note 6)			<u>Please give a description of the facilities for making music you will be providing</u>	
			<u>Will the facilities for making music be indoors or outdoors or both – please tick</u> (please read guidance note 2)	
			Outdoors <input type="checkbox"/>	
Day	Start	Finish	Both <input type="checkbox"/>	
Mon			<u>Please give further details here</u> (please read guidance note 3)	
Tue			<u>State any seasonal variations for the provision of facilities for making music</u> (please read guidance note 4)	
Wed			<u>Non standard timings. Where you intend to use the premises for provision of facilities for making music at different times to those listed in the column on the left, please list</u> (please read guidance note 5)	
Thur				
Fri				
Sat				
Sun				

J

Provision of facilities for dancing Standard days and timings (please read guidance note 6)			Will the facilities for dancing be indoors or outdoors or both – please tick (see guidance note 2)	Indoors <input checked="" type="checkbox"/>
				Outdoors <input type="checkbox"/>
				Both <input type="checkbox"/>
Day	Start	Finish	Please give a description of the facilities for dancing you will be providing Permission for customers to dance within the premises.	
Mon	10:00	00:00	Please give further details here (please read guidance note 3)	
Tue	10:00	00:00		
Wed	10:00	00:00	State any seasonal variations for providing dancing facilities (please read guidance note 4)	
Thur	10:00	00:00		
Fri	10:00		Non standard timings. Where you intend to use the premises for the provision of facilities for dancing at different times to those listed in the column on the left, please list (please read guidance note 5) A further additional hour into the morning following every, Friday, Saturday, Sunday and Monday for each May Bank Holiday, Spring/Whitsun Bank Holiday and every August Bank Holiday weekend. A further additional hour into the morning following every Thursday, Friday, Saturday, Sunday and Monday for the Easter Bank Holiday weekend. A further additional hour every Christmas Eve and Boxing Day. From the start of permitted hours New Years Eve to the close of permitted hours New Years Day. A further additional hour into the morning every St.David's Day, St.Patrick's Day, St.George's Day and St.Andrew's Day.	
Sat		02:00		
Sun		02:00		
	10:00	00:00		

K

Provision of facilities for entertainment of a similar description to that falling within i or j Standard days and timings (please read guidance note 6)			Please give a description of the type of entertainment facility you will be providing Karaoke and other similar type entertainment.		
Day	Start	Finish	Will the entertainment facility be indoors or outdoors or both – please tick (please read guidance note 2)	Indoors	<input checked="" type="checkbox"/>
Mon	10:00	00:00		Outdoors	<input type="checkbox"/>
				Both	<input type="checkbox"/>
Tue	10:00	00:00	Please give further details here (please read guidance note 3)		
Wed	10:00	00:00			
Thur	10:00	00:00	State any seasonal variations for the provision of facilities for entertainment of a similar description to that falling within i or j (please read guidance note 4)		
Fri	10:00				
Sat		02:00	Non standard timings. Where you intend to use the premises for the provision of facilities for entertainment of a similar description to that falling within i or j at different times to those listed in the column on the left, please list (please read guidance note 5)		
	10:00				
Sun		02:00	A further additional hour into the morning following every, Friday, Saturday, Sunday and Monday for each May Bank Holiday, Spring/Whitsun Bank Holiday and every August Bank Holiday weekend. A further additional hour into the morning following every Thursday, Friday, Saturday, Sunday and Monday for the Easter Bank Holiday weekend. A further additional hour every Christmas Eve and Boxing Day. From the start of permitted hours New Years Eve to the close of permitted hours New Years Day. A further additional hour into the morning every St.David's Day, St.Patrick's Day, St.George's Day and St.Andrew's Day.		
	10:00	00:00			

L

Late night refreshment Standard days and timings (please read guidance note 6)			Will the provision of late night refreshment take place indoors or outdoors or both – please tick (please read guidance note 2)	Indoors	<input checked="" type="checkbox"/>
				Outdoors	<input type="checkbox"/>
				Both	<input type="checkbox"/>
Day	Start	Finish	Please give further details here (please read guidance note 3)		
Mon	23:00	00:00			
Tue	23:00	00:00			
Wed	23:00	00:00	State any seasonal variations for the provision of late night refreshment (please read guidance note 4)		
Thur	23:00	00:00			
Fri	23:00		Non standard timings. Where you intend to use the premises for the provision of late night refreshment at different times, to those listed in the column on the left, please list (please read guidance note 5)		
Sat		02:00	A further additional hour into the morning following every, Friday, Saturday, Sunday and Monday for each May Bank Holiday, Spring/Whitsun Bank Holiday and every August Bank Holiday weekend. A further additional hour into the morning following every Thursday, Friday, Saturday, Sunday and Monday for the Easter Bank Holiday weekend. A further additional hour every Christmas Eve and Boxing Day. From the start of permitted hours New Years Eve to the close of permitted hours New Years Day. A further additional hour into the morning every St.David's Day, St.Patrick's Day, St.George's Day and St.Andrew's Day.		
	23:00				
Sun		02:00			
	23:00	00:00			

M

Supply of alcohol Standard days and timings (please read guidance note 6)			Will the supply of alcohol be for consumption (Please tick box) (please read guidance note 7)	On the premises	<input type="checkbox"/>
Day	Start	Finish		Off the premises	<input type="checkbox"/>
Mon	10:00	00:00	State any seasonal variations for the supply of alcohol (please read guidance note 4)	Both	<input type="checkbox"/>
Tue	10:00	00:00			
Wed	10:00	00:00			
Thur	10:00	00:00	Non-standard timings. Where you intend to use the premises for the supply of alcohol at different times to those listed in the column on the left, please list (please read guidance note 5) A further additional hour into the morning following every, Friday, Saturday, Sunday and Monday for each May Bank Holiday, Spring/Whitsun Bank Holiday and every August Bank Holiday weekend. A further additional hour into the morning following every Thursday, Friday, Saturday, Sunday and Monday for the Easter Bank Holiday weekend. A further additional hour every Christmas Eve and Boxing Day. From the start of permitted hours New Years Eve to the close of permitted hours New Years Day. A further additional hour into the morning every St.Davd's Day, St.Patrick's Day, St.George's Day and St.Andrew's Day.		
Fri	10:00				
Sat		02:00			
Sun		02:00			
	10:00				

N

Please highlight any adult entertainment or services, activities, other entertainment or matters ancillary to the use of the premises that may give rise to concern in respect of children (please read guidance note 8)

O

Hours premises are open to the public Standard days and timings (please read guidance note 6)			State any seasonal variations (please read guidance note 4)
Day	Start	Finish	
Mon		00:30	<p>Non standard timings. Where you intend the premises to be open to the public at different times from those listed in the column on the left, please list (please read guidance note 5)</p> <p>A further additional hour into the morning following every, Friday, Saturday, Sunday and Monday for each May Bank Holiday, Spring/Whitsun Bank Holiday and every August Bank Holiday weekend. A further additional hour into the morning following every Thursday, Friday, Saturday, Sunday and Monday for the Easter Bank Holiday weekend. A further additional hour every Christmas Eve and Boxing Day. From the start of permitted hours New Years Eve to the close of permitted hours New Years Day. A further additional hour into the morning every St.Davd's Day, St.Patrick's Day, St.George's Day and St.Andrew's Day.</p>
	10:00		
Tue		00:30	
	10:00		
Wed		00:30	
	10:00		
Thur		00:30	
	10:00		
Fri		00:30	
	10:00		
Sat		02:30	
	10:00		
Sun		02:30	
	10:00		

Please identify those conditions currently imposed on the licence which you believe could be removed as a consequence of the proposed variation you are seeking.

Please tick yes

- I have enclosed the premises licence
- I have enclosed the relevant part of the premises licence

If you have not ticked one of these boxes please fill in reasons for not including the licence, or part of it, below

Reasons why I have failed to enclose the premises licence or relevant part of premises licence

P Describe any additional steps you intend to take to promote the four licensing objectives as a result of the proposed variation:

a) General – all four licensing objectives (b,c,d,e) (please read guidance note 9)

As per current licence.

b) The prevention of crime and disorder

c) Public safety

d) The prevention of public nuisance

e) The protection of children from harm

Please tick yes

- I have made or enclosed payment of the fee
- I have sent copies of this application and the plan to responsible authorities and others where applicable
- I understand that I must now advertise my application
- I have enclosed the premises licence or relevant part of it or explanation
- I understand that if I do not comply with the above requirements my application will be rejected

IT IS AN OFFENCE, LIABLE ON CONVICTION TO A FINE UP TO LEVEL 5 ON THE STANDARD SCALE, UNDER SECTION 158 OF THE LICENSING ACT 2003 TO MAKE A FALSE STATEMENT IN OR IN CONNECTION WITH THIS APPLICATION

Part 5 – Signatures (please read guidance note 10)

Signature of applicant (the current premises licence holder) or applicant’s solicitor or other duly authorised agent (please read guidance note 11). If signing on behalf of the applicant please state in what capacity.

Signature	K. Mackford, TLT
Date	19.11.08.
Capacity	Solicitor to Applicant

Where the premises licence is jointly held signature of 2nd applicant (the current premises licence holder) or 2nd applicant’s solicitor or other authorised agent (please read guidance note 12). If signing on behalf of the applicant please state in what capacity.

Signature	
Date	
Capacity	

Contact name (where not previously given) and address for correspondence associated with this application (please read guidance note 13) Barry Richards TLT Solicitors One Redcliff Street			
Post town	Bristol	Post code	BS1 6TP
Telephone number (if any)	0117 917 7612		
If you would prefer us to correspond with you by e-mail your e-mail address (optional) barry.richards@tltsolicitors.com			

Notes for Guidance

This application cannot be used to vary the licence so as to extend the period for which the licence has effect or to vary substantially the premises to which it relates. If you wish to make that type of change to the premises licence you should make a new premises licence application under section 17 of the Licensing Act 2003.

1. Describe the premises. For example the type of premises, its general situation and layout and any other information which could be relevant to the licensing objectives. Where your application includes off-supplies of alcohol and you intend to provide a place for consumption of these off-supplies you must include a description of where the place will be and its proximity to the premises.
2. Where taking place in a building or other structure please tick as appropriate. Indoors may include a tent.
3. For example state type of activity to be authorised, if not already stated, and give relevant further details, for example (but not exclusively) whether or not music will be amplified or unamplified.
4. For example (but not exclusively), where the activity will occur on additional days during the summer months.
5. For example (but not exclusively), where you wish the activity to go on longer on a particular day e.g. Christmas Eve.
6. Please give timings in 24 hour clock (e.g. 16:00) and only give details for the days of the week when you intend the premises to be used for the activity.
7. If you wish people to be able to consume alcohol on the premises please tick on, if you wish people to be able to purchase alcohol to consume away from the premises please tick off. If you wish people to be able to do both please tick both.
8. Please give information about anything intended to occur at the premises or ancillary to the use of the premises which may give rise to concern in respect of children regardless of whether you intend children to have access to the premises, for example (but not exclusively) nudity or semi-nudity, films for restricted age groups, the presence of gaming machines.
9. Please list here steps you will take to promote all four licensing objectives together.
10. The application form must be signed.
11. An applicant's agent (for example solicitor) may sign the form on their behalf provided that they have actual authority to do so.
12. Where there is more than one applicant, both applicants or their respective agents must sign the application form.
13. This is the address which we shall use to correspond with you about this application.

COPY OF CURRENT LICENCE



PREMISES LICENCE

Receipt: AG 766729

Premises Licence Number: LN00003543

This Premises Licence has been issued by:

**The Licensing Authority, London Borough of Haringey,
Technopark, Ashley Road, Tottenham, London N17 9LN**

Signature:.....

Date: 24TH November 2005,
10th September 2008

Part 1 – PREMISES DETAILS

Postal Address of Premises or, if none, Ordnance Survey map reference or description:

**WESTBURY PUBLIC HOUSE
57 WESTBURY AVENUE
WOOD GREEN
LONDON
N22 6SA**

Telephone: 020 8888 2045

Where the Licence is time limited, the dates:

N/A

Licensable activities authorised by the Licence:

Regulated Entertainment: Live Music, Recorded Music & Provision of Facilities for Dancing

Supply of Alcohol

The times the Licence authorises the carrying out of licensable activities:

Supply of Alcohol

Monday to Wednesday 1200 to 2300

Thursday to Saturday 1200 to 0000

Sunday 1200 to 2230

New Years Eve Until 0300

Recorded Music

Thursday to Saturday 1900 to 0000

Live Music & Provision of Facilities for Dancing

Monday & Thursday to Saturday 1900 to 0000

New Years Eve Until 0400





Premises may conduct licensable activities until 0000 for the for Bank Holiday Weekends, Christmas Day St Georges Day & St Patrick's Day

The opening hours of the premises:

Monday to Wednesday	1200 to 2330
Thursday to Saturday	1200 to 0030
Sunday	1200 to 2300
New Years Eve	Until 0345

Opening time extended until 0045 for the for Bank Holiday Weekends, Christmas Day St Georges Day & St Patrick's Day

Where the Licence authorises supplies of alcohol whether these are on and/or off supplies:

Supply of alcohol for consumption ON the premises only.

Part 2

Name, (registered) address, telephone number and e-mail (where relevant) of holder of Premises Licence:

Punch Taverns Plc
Jubilee House
Second Avenue
Burton Upon Trent
DE14 2WF

Registered number of holder, for example company number, charity number (where applicable):

Name, address and telephone number of designated premises supervisor where the Premises Licence authorises the supply of alcohol:

Kay Bradshaw
13B Cranwich Road
London N16 5HZ

Personal Licence number and issuing authority of personal licence held by designated premises supervisor where the Premises Licence authorises for the supply of alcohol:

LBH-PER-T-0668

Issued by London Borough of Hackney

Expires: 20/03/2018





Annex 1 -Mandatory Conditions

(2) Supply of alcohol:

No supply of alcohol may be made under the premises licence-

- (a) at a time when there is no designated premises supervisor in respect of the premises licence, or
- (b) at a time when the designated premises supervisor does not hold a personal licence or his personal licence is suspended.
- (3) The second condition is that every supply of alcohol under the premises licence must be made or authorised by a person who holds a personal licence.





Annex 2 – Conditions consistent with the Operating Schedule

THE PREVENTION OF CRIME AND DISORDER

All drinks sold for consumption outside premises (i.e.-beer garden) will be served in toughened glass or plastic containers.

PUBLIC SAFETY

All escape routes and exits will be kept unobstructed and in good order.

All fire doors will be maintained and not held open other than with approved devices.

THE PREVENTION OF PUBLIC NUISANCE

Windows and doors will be kept shut during live music.

Signage will be displayed requesting that people please leave the premises quietly and respect the neighbours.

THE PROTECTION OF CHILDREN

No one under the age of 18 will be allowed on the premises after 21.00 hours.

Alcohol may only be sold to individuals over the age of 18 with valid proof of identification with one of the following:

- A valid passport
- A photo driving license issued in a European Union Country
- A proof of age standard card system
- A citizen card, supported by the Home Office

If any licensed doorman or member of staff of the premises has any doubt as to the age of any potential patron, then that person will be refused entry.





Annex 3 – Conditions attached after a hearing by the licensing authority

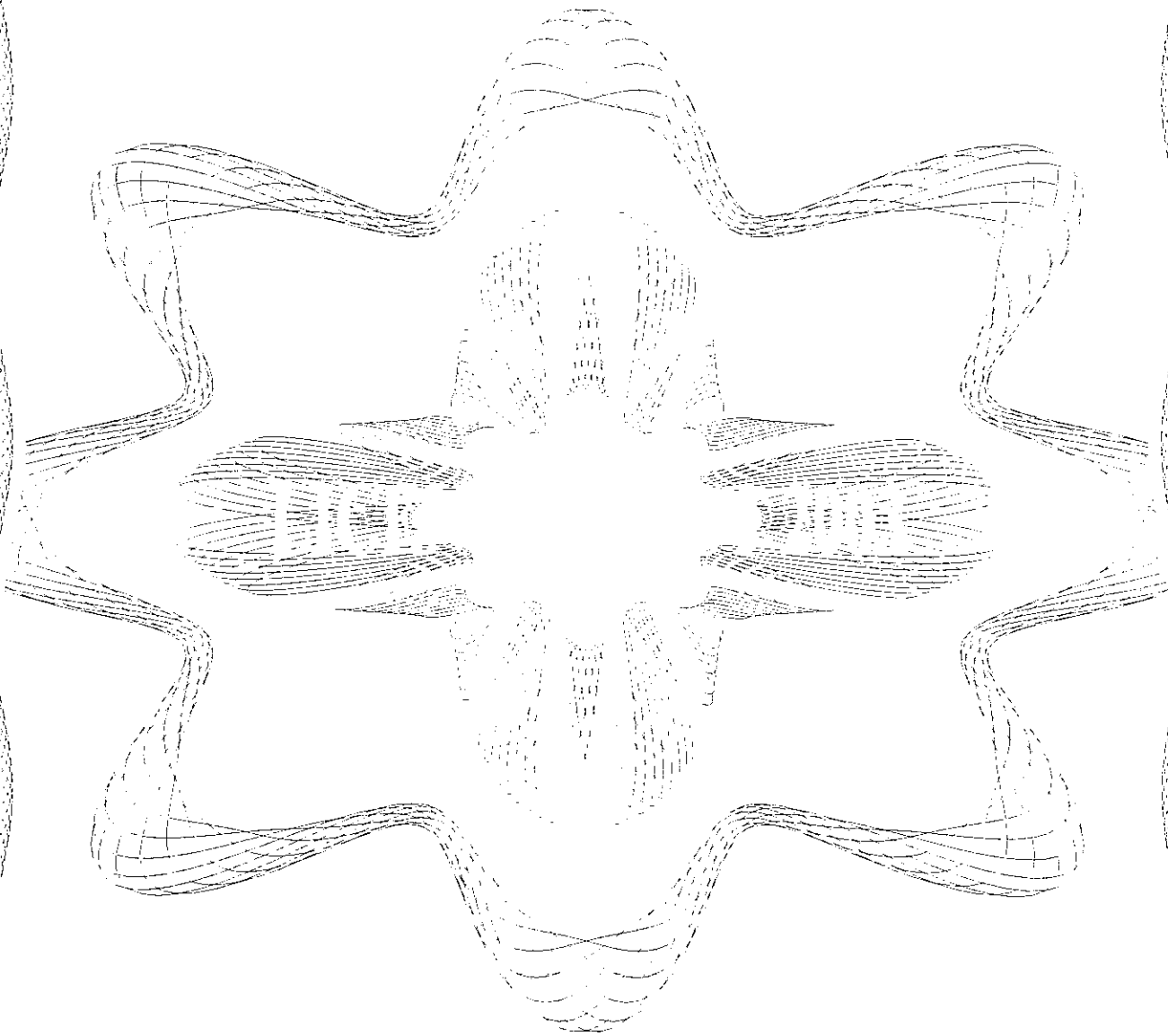



Annex 4 – Plans

LODGED WITH LICENSING AUTHORITY

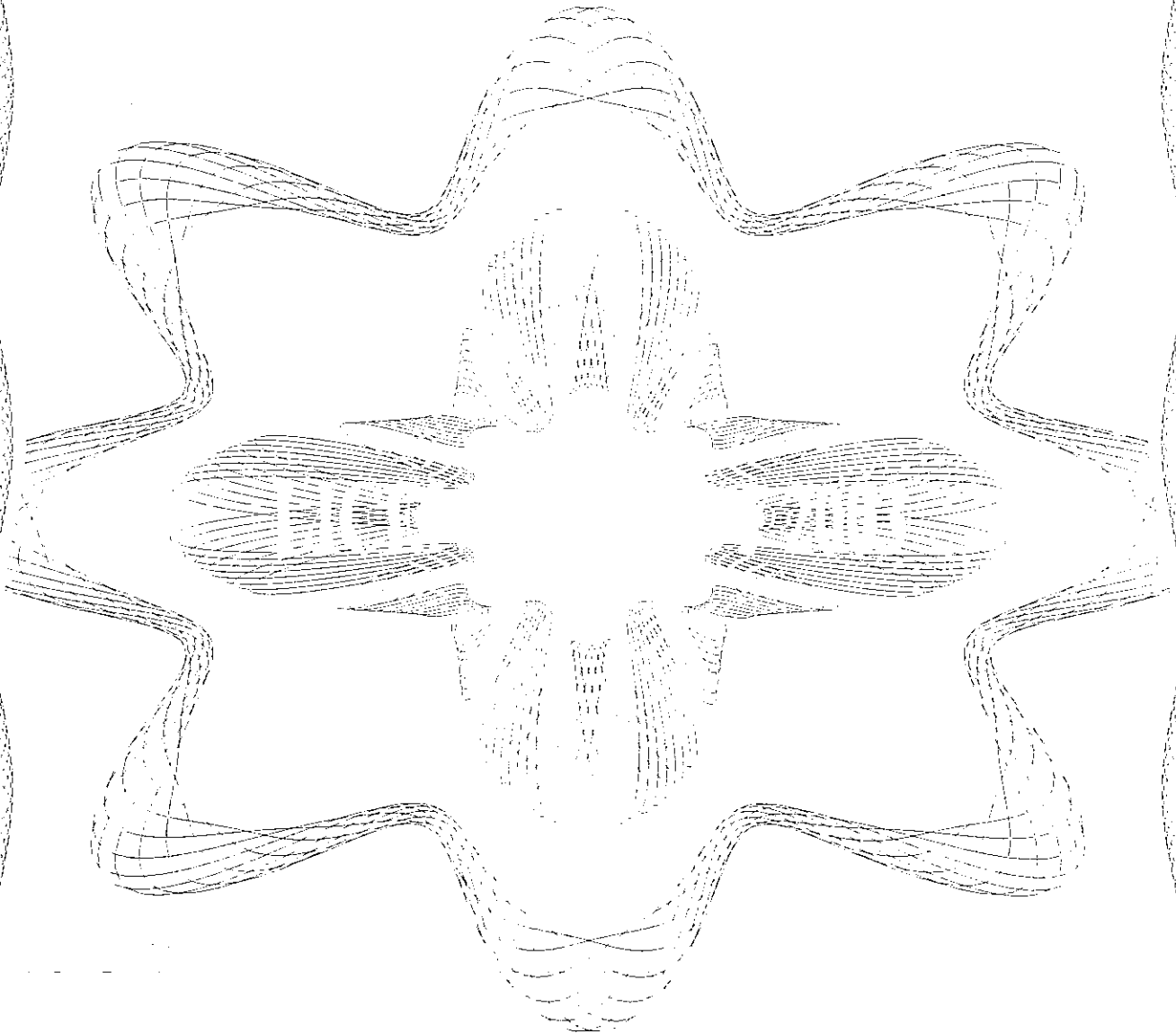



LICENSING ACT 2003
Section 24

PREMISES LICENCE SUMMARY

Receipt: AG766729

Premises Licence Number: LN00003543

This Premises Licence has been issued by:

**The Licensing Authority, London Borough of Haringey,
Technopark, Ashley Road, Tottenham, London N17 9LN**

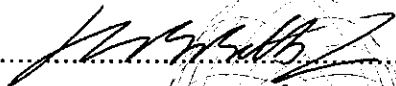
Signature: 

Date: 24TH November 2005,
10th September 2008

Part 1 – PREMISES DETAILS

Postal Address of Premises or, if none, Ordnance Survey map reference or description:

**WESTBURY PUBLIC HOUSE
57 WESTBURY AVENUE
WOOD GREEN
LONDON
N22 6SA**

Telephone: 020 8888 2045

Where the Licence is time limited, the dates:

Not applicable

Licensable activities authorised by the Licence:

Regulated Entertainment: Live Music, Recorded Music & Provision of Facilities for Dancing

Supply of Alcohol

The times the Licence authorises the carrying out of licensable activities:

Supply of Alcohol

Monday to Wednesday 1200 to 2300

Thursday to Saturday 1200 to 0000

Sunday 1200 to 2230

New Years Eve Until 0300

Recorded Music

Thursday to Saturday 1900 to 0000

Live Music & Provision of Facilities for Dancing





PREMISES DETAILS [CONT'D]

Monday & Thursday to Saturday 1900 to 0000
New Years Eve Until 0400

Premises may conduct licensable activities until 0000 for the for Bank Holiday Weekends, Christmas Day St George's Day & St Patrick's Day

The opening hours of the premises:

Monday to Wednesday 1200 to 2330
Thursday to Saturday 1200 to 0030
Sunday 1200 to 2300
New Years Eve Until 0345

Opening time extended until 0045 for the for Bank Holiday Weekends, Christmas Day St George's Day & St Patrick's Day

Where the Licence authorises supplies of alcohol whether these are on and/or off supplies:

Supply of alcohol for consumption **ON** the premises

Name, (registered) address of holder of Premises Licence:

Punch Taverns Plc
Jubilee House
Second Avenue
Burton Upon Trent
DE14 2WF

Registered number of holder, for example company number, charity number (where applicable):

Name of designated premises supervisor where the Premises Licence authorises the supply of alcohol:

Kay Bradshaw

State whether access to the premises by children is restricted or prohibited:



APPENDIX 2

REPRESENTATION FROM METROPOLITAN POLICE



Your reference:

Our reference: 356/2008

Date: 1 December, 2008

Ms D.BARRETT
ENVIRONMENTAL CONTROL SERVICES
TECHNO PARK
ASHLEY ROAD
TOTTENHAM N.17

Metropolitan Police Service

Licensing
Quicksilver Patrol Base
Western Road
Wood Green
N.22 6UH

Tel: 0203 – 276 -0150

Dear Ms. Barrett

Re:- Application for a Variation to a Premises Licence:-

The Westbury Tavern 57 Westbury Avenue N.22

With reference to the above application Police have considered the application and wish to make the following representation.

1.This is under the Prevention of Crime & Disorder objective:-

Due to the later hours applied for I feel that a Digital C.C.T.V. system be installed at the premises. The system should be capable of recording for 28 days and should be able to take digital images of people entering the premises. The recordings must be made available to Police officers and the Local Authority on request.

Yours Sincerely

Geoffrey Parker
Licensing
Quicksilver Patrol Base

C.C. TLT Solicitors

APPENDIX 3

REPRESENTATION FROM NOISE TEAM

Licensing Consultation - Internal Memo

To: Daliah Barrett-Williams

From: George Roberts (Noise)

Cc: Derek Pearce

Our Reference: WK103759

Date: 17/12/08

Premises: The Westbury, 57 Westbury Avenue, London, N22 6BS.

Type of application: Variation

I would like to confirm that I have considered the above proposal with regard to the prevention of public nuisance on behalf of the Enforcement Response (Noise) Team & would like to make representations to the Variation on the following grounds:

Noise from music played at the premises is likely to affect local residents if played into the early hours of the morning without suitable conditions.

The operating schedule does not address the prevention of public nuisance from:

- airborne entertainment noise
- Noise generated from deliveries
- Noise from plant and machinery

Supporting Information

Complaint of loud music on 6/12/08, which was not loud enough to be actionable (ref WK102653)

Complaint of loud music on 1/11/08, warning letter sent (ref WK98153)

Complaint of loud music on 13/6/08, music had stopped (ref WK79038)

Complaint of loud music on 9/6/08, which was not loud enough to be actionable (ref WK78420)

Complaint of loud music on 3/5/08, warning letter sent (ref WK76022)

Complaint of loud music on 26/4/08, which was not loud enough to be actionable (ref WK72941)

Complaint of dog barking on 14/12/7, problem not witnessed, and a letter was sent informing that we had received reports of a problem (ref WK58142)

I would recommend the following alterations/conditions to the operating schedule:

Prevention of nuisance from noise/vibration

Airborne

All doors and windows will remain closed during the licensed activities. Where a door is used for patrons to enter or leave the premises the door will be fitted with a self-closing device and staff told to ensure that it is not propped open. A member of staff shall be positioned at the door to ensure it is opened for as brief a period as possible.

Entry to the premises will be restricted to a particular entrance whilst the premises is being used of the licensed activity located on Westbury Avenue.

Entrance/exit from the premises whilst licensable activities are ongoing shall be via a lobbied door to minimise noise breakout.

Where necessary adequate and suitable mechanical ventilation should be provided to public areas.

Deliveries And Collections

Deliveries and collections associated with the premises will be arranged between the hours 0800 and 1800 hrs so as to minimise the disturbance caused to the neighbours.

Plant and machinery

All plant and machinery is correctly maintained and regularly serviced to ensure that it is operating efficiently and with minimal disturbance to neighbours arising from noise.

APPENDIX 4

REPRESENTATIONS FROM INTERESTED PARTIES

Dear Daliah Bennett

With reference to the licensing act 2003
Notification of a variation of premises licence
for The Westbury Tavern, 57 Westbury Avenue
Wood Green N.22.6SA.

I and all my family resident at the above
address, strongly object to the change of
provision of licence on the grounds of noise
and disorderly behaviour at unsocial hours, and
The problem of parking in an already busy
residential parking zone.

If the change of licence goes ahead we
would like a reduction in Council Tax and
parking permit charges.

Yours Sincerely

MRS R. Cioppi

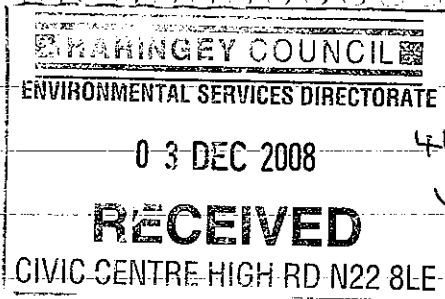

46. Willington Road
Wood Green
London. N22 6SD

1st. Dec. 2008.

Dear Ms. Barrett-Williams

I would like to object to the application for a variation to the licensing of 'The Westbury Tavern' 57 Westbury Avenue Wood Green. N22 6SA.

It will be a great nuisance to local residents having loud music playing until 2.00 AM. I imagin in the summer with everyone outside until the early hours of the morning.

I feel very sorry for the residents of Lakesfield Road.

Yours Sincerely
Helen Pearce.

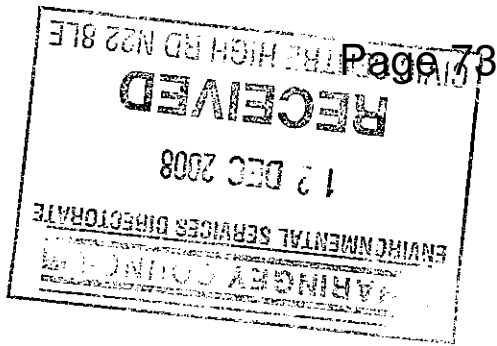

Andrew Savva
5 Lakefield Road
Wood Green
London, N22 6RR
Tel: 020 88814401

10 Dec 2008

Dear Daliah Barrett,

I am writing in response to your letter dated 21 Nov 2008 – The notification of a variation of premises license for the Westbury Tavern, 57 Westbury Avenue, Wood Green, London N22 6SA. I am writing for myself and on behalf of my parents (Costas Savva and Sophia Savva) who all live at the above address. Costas Savva is the house owner.

We are all strongly opposed to the Westbury Tavern extending their hours for music and the supply of alcohol as outlined in the notification for the following reasons:

- 1) The sound level of the music played on certain days is sometimes so loud, that my parents cannot sleep till it has finished. It is also difficult to hear the television in our living room whilst the music is at that level. This will just get worse with extended hours for music.
- 2) People sometimes loiter outside the Westbury Tavern after it has closed and this can be a little intimidating when it is a group of loud intoxicated young men. They sooner or later disperse on most occasions, but sometimes hang around for over an hour after closing and create a lot of noise when they loudly talk and laugh among themselves. This further disrupts my parents' sleep and will worsen with later opening hours.
- 3) We occasionally find glasses and glass bottles in the street where we and our visitors park our cars, and have on a few occasions found empty glasses and glass bottles on the wall outside our house. This is especially frustrating, because there are tables outside the Westbury Tavern that people can leave glasses and bottles even after the pub has closed. I have an eight-year old niece that comes to our house quite regularly and we always have to be on the lookout for any broken glass that may be outside our house. I have also inadvertently driven over a glass bottle that was left in the street near my car. The increased business resulting from music played on the premises on extra days (especially the increase in younger customers) combined with later opening hours will only exacerbate this problem.
- 4) Since the Westbury Tavern has had music and the corresponding increase in younger customers, there has also been an increase in loud, angry, verbal disputes and physical fights outside the pub. Less than two weeks ago – on the night of Saturday 29 Nov 2008 (Sunday morning) at 0100 – I called the police because a fight had broken out in the street between the Westbury Tavern and our house. Longer opening hours (especially with music) will just worsen this already regrettable situation.

5) If the license applied for (as outlined in your letter/notice) is granted, then it will very likely make it extremely difficult for my father to sell his house should he choose to do so, because it is highly unlikely that potential buyers will want to live directly opposite a pub that serves alcohol and has loud music till midnight Sunday to Thursday and till 0200 Fridays and Saturdays – especially with the attendant problems I have listed above.

In light of the reasons I have outlined in this letter, my family and I would consider it very surprising and quite distressing if the council granted the license in question. I sincerely hope that you will empathize with our concerns and deny the application.

Yours sincerely,

A handwritten signature in black ink, appearing to read 'Andrew Savva', with a long horizontal flourish extending to the right.

Andrew Savva

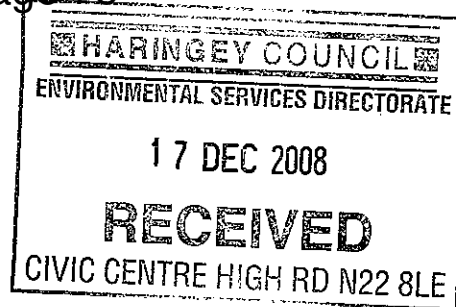

11B Lakefield Road,
Woodgreen,
LONDON,
N22 6RR.

10th December 2008

Re: LICENSING ACT 2003-NOTIFICATION OF A VARIATION OF PREMISES
LICENSE FOR THE WESTBURY TAVERN, 57 WESTBURY ROAD,
WOODGREEN, LONDON, N22 6SA.

Dear Sir/Madam,

I would like to register my objection to the application made by the Westbury Tavern for a change to their premises license.

As a local resident living close to the pub the reasons for my objections are as follows:

1. **The Prevention of Public Nuisance.** With increased opening hours and the facilities for dancing will mean a greater amount of noise and disturbance coming from the pub. It is noisy enough at the moment but these changes will mean it will be even more difficult to get to sleep. The noise proofing of the pub is not that good anyway and there will inevitably be more people outside smoking and making noise. This will be especially bad during the summer months when more people will be there and windows will be open.
2. **Public Safety/The Prevention of Crime and Disorder.** With longer opening hours and potentially greater numbers of people consuming more alcohol I believe there will be more instances of violence, both inside and outside of the pub. Indeed there have already been a number of instances at the pub where the Police have had to be called (most recently Saturday 29th November). This pub is in a largely residential area where this sort of behaviour is not acceptable.

I would also like to point out that I'm not against having the pub. It has been good to see the new owners refitting the pub and improving the general state of repair of the building. It also provides an important social meeting place for the local community. However I think these latest proposals are too much and are not in-keeping with what a local pub should be.

May I also request that my name and address are withheld from the licensee.

Yours Sincerely,

A handwritten signature in black ink, appearing to read "Michael Scott".

Michael Scott.

09 December 2008

HARINGEY COUNCIL

Licensing Team

1st Floor, Lee valley Technopark,

Ashley Road

Tottenham, London

N17 9LN

MRS. MARIA GOMES

13A Lakefield Road

LONDON

N22 6RR

Dear Sir/Madam

Re: The Westbury Tavern, 57 Westbury Avenue
Wood Green - London - N22 6SA

I understand that the above mentioned public house has made an application for a late license.

I would like to inform you that I am strongly opposed to this application. A few times recently, the landlord has remained open until late. Last Saturday, the 29th of November, a fight broke out at 1:30 a.m. amongst the pub customers. These incidents have become quite common lately. The noise of the customers when leaving the premises is unacceptable. My young child has been woken by the noise very often. Two months ago, I had been harassed when walking home late at night by a number of customers.

This situation concern me very much as I fear for my safety as well as the safety of my family.

Please ensure that the Environmental Protection Act 1990 is carried out as the noise and the concern for me and my family safety is unacceptable.

I look forward to your response and thank you in advance for your assistance in this matter.

Could you please ensure that my name and address is withheld.

Yours faithfully



Maria Gomes

Perryman Dylan

From: [redacted] .uk]
 Sent: *Remain*
 To: *Anonymous*
 Subject: *to* ury Tavern, Wood Green
 Attachments: *owner.*

Licensing Team
 1st Floor, Lee valley Technopark,
 Ashley Road, Tottenham, London
 N17 9LN

Wood Green, 10th December 2008.

Re: 57 Westbury Tavern, Wood Green, London, N22 6SA

Dear Daliah,

We are writing regarding the letter received around the 21st November asking for our views regarding the change of openings times for the above mentioned pub.

This premise is just a few metres from our flat and the nuisance is a frequent issue. If not only that there are also fights late in the night. Police called sometimes.

They already do parties over there with customers' staying for longer than the time set on the paper you have sent to us.

For the past two weekends they have opened the premises until 2am at least. We know that because, two weeks ago, there where a huge fight with a lots of screaming. The Police were called at around 1:15am. There weren't even supposed to be open at this time anyway.

Our flat has been broken into less than 6 months ago, and our neighbours flat too, less than a month ago, what makes us thinking that since this pub changed his owner things have changed in the neighbourhood.

We have talked with some neighbours and they have expressed their concerns too.

When we decided to move to this area, we never imagined we would be fronted with such an issue. We have always looked for a calm and safe neighbourhood to bring up our child.

Please do not change it.

Looking forward to hearing from you with a negative response to their request.

I would like to request that you omit our names from the applicant. He can be aware of our concerns but not our names.

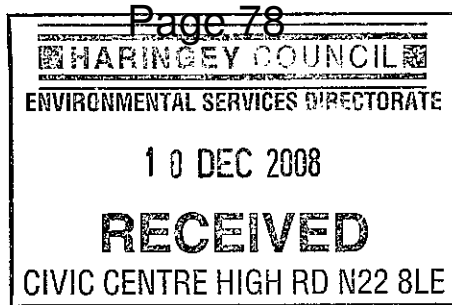

Mr. James Mulondo
59 Westbury Avenue
Wood Green
London
N22-6SA

Daliah Barrett
Haringey Council
Licensing Team
1st Floor
Lee Valley Technopark
Ashley Rd
Tottenham
London
N17 9LN

8th December 2008

Re: The Westbury Tavern, 57 Westbury Ave, London, N22

I am writing to you about the letter you sent dated 21/11/08, regarding the variation of the premises license for The Westbury Pub.

As you can see from my address, I live next door to the pub, and I would like you to know that I do not agree with the proposed plans for the provision of regulated entertainment, the provision of supplying alcohol and late night refreshment and the extension in the opening hours to do so.

I do not think it is fair or appropriate to extend the hours of this premises as it is in a residential area. I believe that the noise from the music will be too loud and prevent me from sleeping. It will be unacceptable to be going on until
I will be protesting this will be

an even bigger problem as I, and I am sure most people, sleep with open windows.

Since the Smoking ban, many people now spill out onto the street in order to smoke, and of course they drink outside too. There is a considerable increase in noise, litter and also glass bottles and glasses left outside. The later the pub is open the worse this will get, in terms of nuisance and litter.

I often open my front door to find broken glass and bottles. On many occasions there has been disorderly and noisy behaviour and even fighting outside my front door, and I fear that the extension of the license will only worsen the situation.

I also believe that by serving alcohol later and allowing music, this will attract people from outside the area and make it rowdier.

I do not object to people having fun and socialising, but I must point out that this is a residential area and not a High street, therefore the consequences of the pub staying open longer and serving alcohol ^{later} and providing music, will affect many people, including families with young children.

I hope my views will be taken into consideration when you make your decision.

Yours Sincerely

J. Mulondo,
James Mulondo

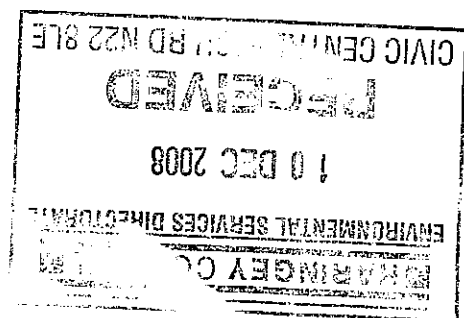

Licensing Team
1st Floor, Lee valley Technopark,
Ashley Road, Tottenham, London
N17 9LN

Wood Green, 10th December 2008.

Re: 57 Westbury Tavern, Wood Green, London, N22 6SA

Dear Daliah,

We are writing regarding the letter received around the 21st November asking for our views regarding the change of openings times for the above mentioned pub.

This premise is just a few metres from our flat and the nuisance is a frequent issue. If not only that there are also fights late in the night. Police called sometimes.

They already do parties over there with customers' staying for longer than the time set on the paper you have sent to us.

For the past two weekends they have opened the premises until 2am at least. We know that because, two weeks ago, there where a huge fight with a lots of screaming. The Police were called at around 1:15am. There weren't even supposed to be open at this time anyway.

Our flat has been broken into less than 6 months ago, and our neighbours flat too, less than a month ago, what makes us thinking that since this pub changed his owner things have changed in the neighbourhood.

We have talked with some neighbours and they have expressed their concerns too.

When we decided to move to this area, we never imagined we would be fronted with such an issue. We have always looked for a calm and safe neighbourhood to bring up our child.

Please do not change it.

Looking forward to hearing from you with a negative response to their request.

I would like to request that you omit our names from the applicant. He can be aware of our concerns but not our names.

Mrs and Mr Cintra
13 Lakefield Road,
N22 6RR

08 December 2008

HARINGEY COUNCIL

Licensing Team

1st Floor, Lee valley Technopark

Ashley Road

Tottenham, London

N17 9LN

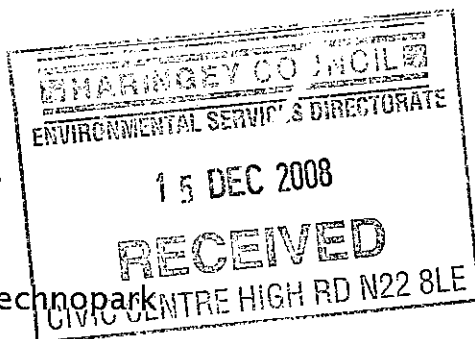

MR. JOÃO FERNANDES

16 Lakefield Road

LONDON

N22 6RR

Dear Sir/Madam

Re: The Westbury Tavern, 57 Westbury Avenue
Wood Green - London - N22 6SA

I understand that the above mentioned public house has made an application for a late license.

I would like to inform you that I am strongly opposed to this application. A few times recently, the landlord has remained open until late. Last Saturday, the 29th of November, a fight broke out at 1:30 a.m. amongst the pub customers. These incidents have become quite common lately. The noise and the use of obscene language of the customers when leaving the premises is unacceptable. I live here over 30 years and I have never witnessed this kind of behaviour before. I would like to sleep through the night without having to wake up every ten minutes with noise.

This situation concern me very much as I fear for my safety as well as the safety of my family.

I look forward to your response and thank you in advance for your assistance in this matter.

Could you please ensure that my name and address is withheld.

Yours faithfully

JOÃO FERNANDES

This page is intentionally left blank